



Free-cut series strip

P/N : RCC0GX06A-DJ

RCC0GX06B-DJ

Areas of application

- Landscape lighting, facade lighting, steps, bridges, roads, shape, etc.

Product main benefits

- High quality 2835 SMD LED
- Calendaring copper processing for FPC,
- more stronger and reliable
- Uniform lighting, dot free
- Single led per unit, cut freely
- Excellent weather and corrosion resistance
- 2700K-6500K, other color available



Product numbers	Input voltage	Rated current	Typical power	Color rendering index	Wavelength/Color or temperature	Lumen	Luminous efficiency
RCC0GR06A-DJ	12V DC	600mA/m	7.2W/m	/	620~625nm	100lm	/
RCC0GG06A-DJ	12V DC	600mA/m	7.2W/m	/	520~528nm	70lm	/
RCC0GB06A-DJ	12V DC	600mA/m	7.2W/m	/	465~470nm	60lm	/
RCC0GY06A-DJ	12V DC	600mA/m	7.2W/m	/	590-596nm	90lm	/
RCC0GO06A-DJ	12V DC	600mA/m	7.2W/m	/	600-605nm	270lm	/
RCC0GX06A-DJ	12V DC	600mA/m	7.2W/m	>80	2700K	370lm	51lm/W
					3000K	390lm	54lm/W
					4000K	410lm	57lm/W
					5000K	410lm	57lm/W
					6500K	380lm	53lm/W
RCC0GX06B-DJ	24V DC	300mA/m	7.2W/m	>80	2700K	380lm	53lm/W
					3000K	400lm	56lm/W
					4000K	420lm	58lm/W
					5000K	420lm	58lm/W
					6500K	390lm	55lm/W

-Test environment temperature 25°C ±2°C

-All above data is typical value, flux tolerance ±10%, beam angle tolerance ±5°, wavelength tolerance ±2nm, power tolerance ±5%.

Photometrical data

Photometric data

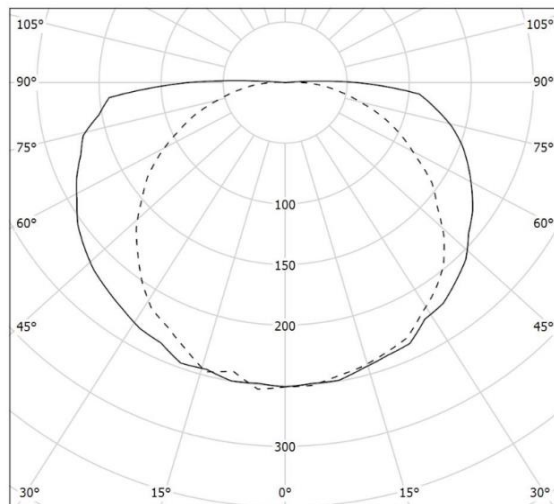

Beam angle(50%I_{max}) : 150°

Section view

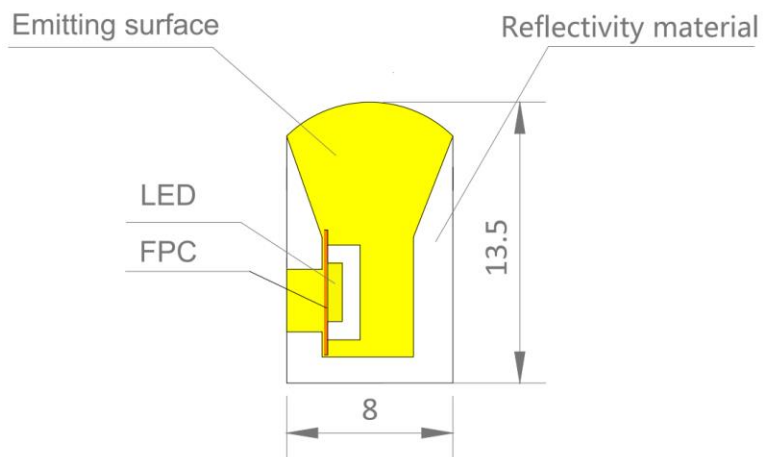

Unit: mm

Unit: mm

RCC0GX06A-DJ

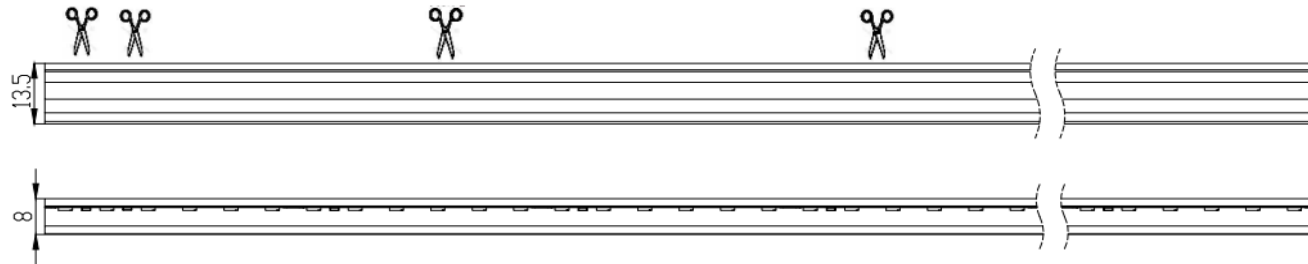

RCC0GX06B-DJ

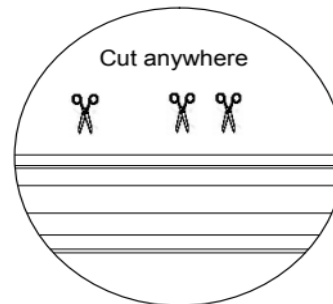
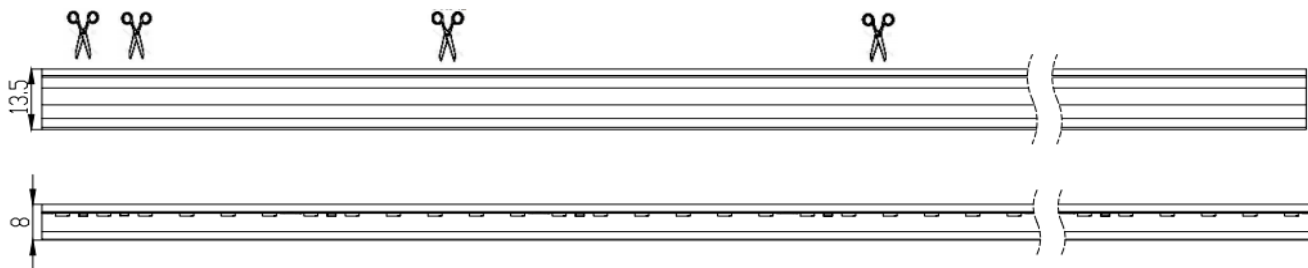

RCC0GX06A-DJ

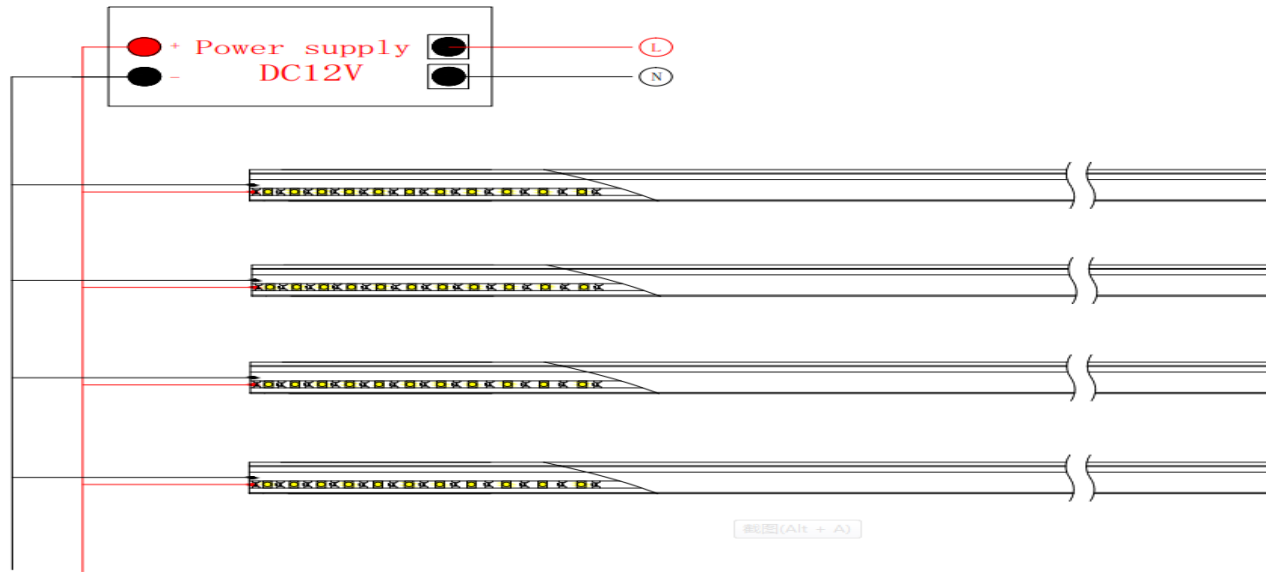

RCC0GX06B-DJ

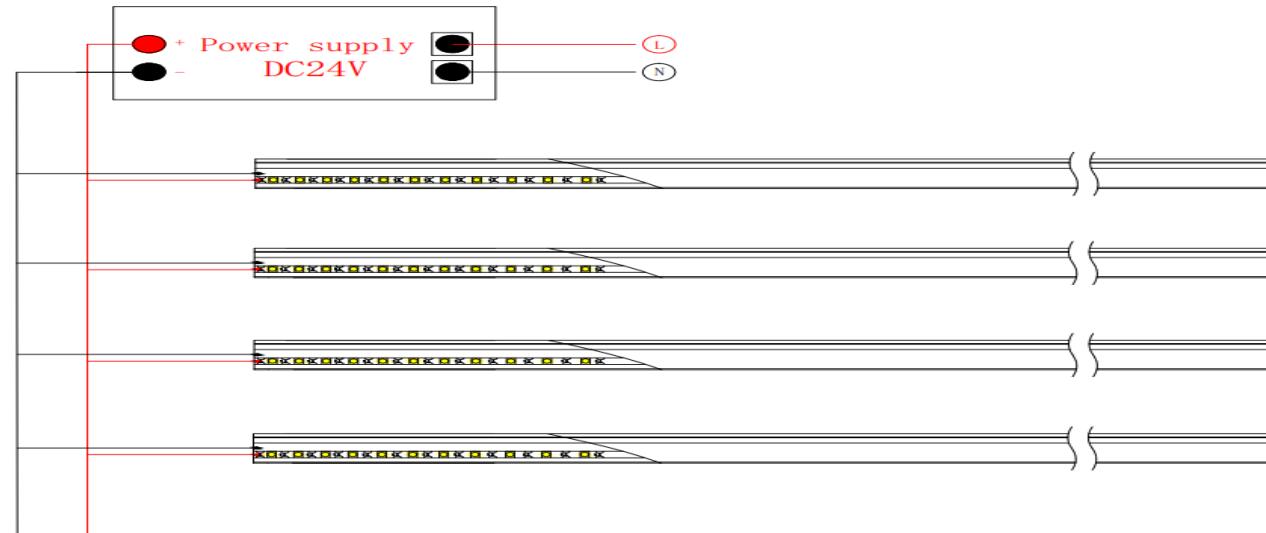

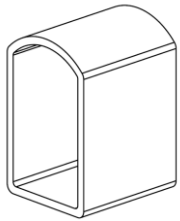

Head up-bottom

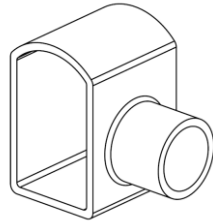

Head cup-side

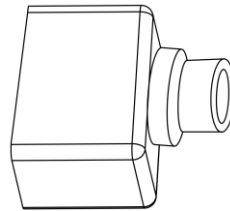

Head up- straight

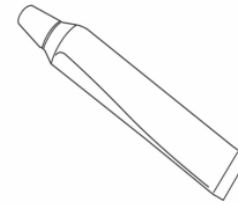

Sealing glue

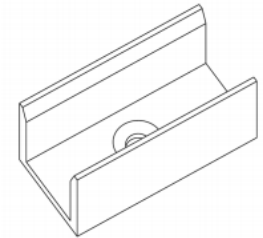

Mounting base

Environmental and application condition

Operation temperature	-25°C~50°C
Storage temperature	-40°C~70°C
Maximum surface temperature (Tc)	65°C

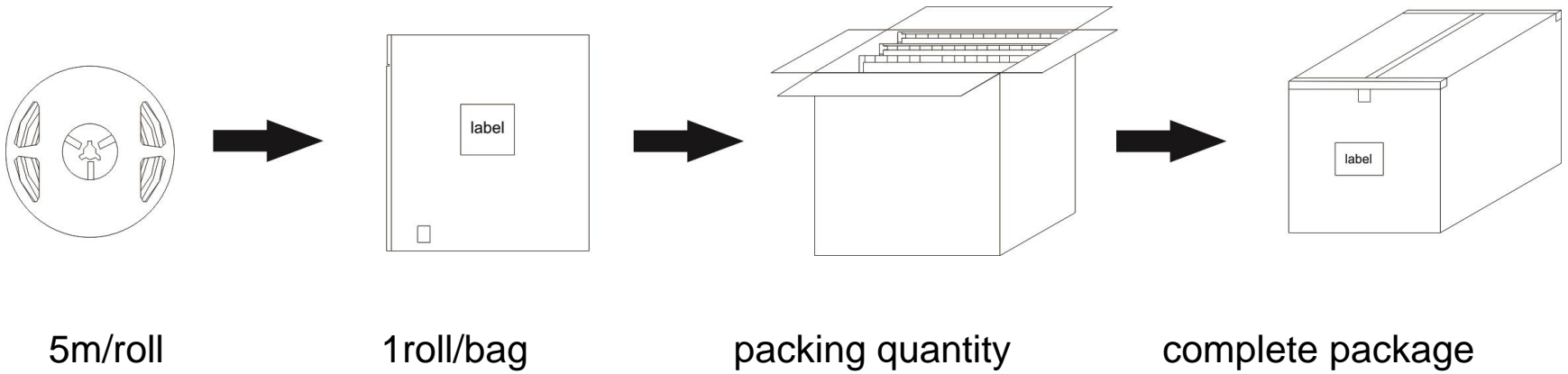

Model NO.	Product Size	Inner Carton Size	Outer Carton Size	Packing Quantity	Gross Weight
RCC0GX06A-DJ	5000*8*13.5mm	/	37*34*34CM	20bags	12kg
RCC0GX06B-DJ	5000*8*13.5mm	/	37*34*34CM	20bags	12kg

Supplementary Product Information

- Installation of LED modules (with power supplies) needs to be made under consideration of all valid regulations and norms.
- Installation by qualified electrician only.
- Please drive the led strip with isolated power, and the ripple of the constant voltage source should be less than 5%.
- Please do not bend the strip into an arc with a diameter less than 20mm to ensure the longevity and reliability.
- Do not fold it in case any damage of LED beads.
- Do not pull the power wire hard to ensure the longevity. Any crash may damage the colloidal surface is prohibited.
- Please make sure the wire is connected to the anode and cathode correctly. The power output should be consistent with the voltage of the strip to avoid damage.
- LED lights should be stored in dry, sealed environment. Please only unpack it before usage. Ambient temperature: $-20^{\circ}\text{C} \sim +40^{\circ}\text{C}$. Storage temperature: $-25^{\circ}\text{C} \sim +60^{\circ}\text{C}/60\%\text{RH}$.
- Please use the strips without waterproof within indoor environment with humidity less than 70%.
- Please be careful during operation. Do not touch the AC power supply in case of electric shock.
- Please leave at least 20% power for the power supply during using to ensure there is enough power supply to drive the product.
- Do not use any acid or alkaline adhesives to fix the product (e.g.: glass cement).
- Must have extra power supply if the working length exceeds the maximum run length.
- The joints of extended strips should be deal with waterproof when using waterproof products.